



DIN 6331 Flange Nuts

Leader-Fastener is a manufacturer and distributor of **DIN 6331 Flange Nuts**. We have a complete line of service from having invested in production plants, export department and to having a quality control team and center to meet your requirements. We regard quality as the life of the company. We persist in good quality as the first policy and have established a set of quality control and inspection system according to the international standard. We have carried out ISO9001 Quality Guarantee System in every course of production, transportation and selling. We do hope we could be your partner in business by topping quality, knight service and

competitive price in the near future and be your friends as well.

Din 6331 Flange Nuts are used for applications where frequent tightening and untightening is required; the flange of the nut eliminates the need for washers.

Metric **DIN 6331 Flange Nuts** are hex nuts that are thicker than standard metric hex nuts. **DIN 6331 metric hex nuts** have a height of 1.5 x the diameter. Also one of the faces has a round collar extending outward increasing the bearing surface area of the nut.

Product Specification of DIN 6331 Flange Nuts

Material : Carbon steel, Stainless steel, Alloy Steel, Brass.

Finishment: Black, Zinc Plated, Zinc Yellow, HDG, Phosphate, DACROMET, Geomet, Magin, Ruspert, Teflon, etc.

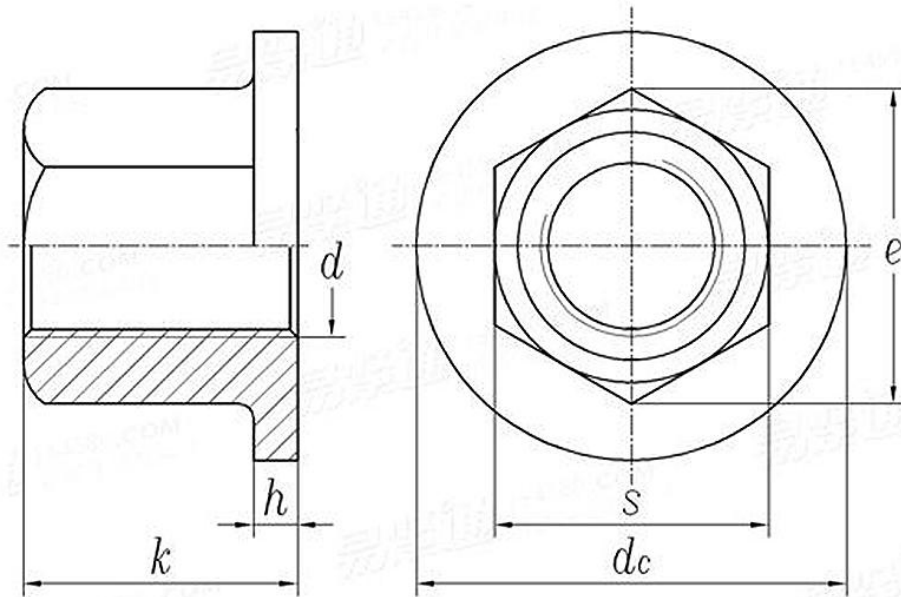
DIN 6331 - 2003 Hexagon Collar Nuts with a Height of 1.5d

Screw Thread		M6	M8	M10	M12	M16	M20	M24	M27	M30	M36	M42	M48
D													
P	Pitch	1	1.25	1.5	1.75	2	2.5	3	3	3.5	4	4.5	5
h	Nominal Size (js14)	3	3.5	4	4	5	6	6	7	8	10	12	14
	max	3.125	3.65	4.15	4.15	5.15	6.15	6.15	7.18	8.18	10.18	12.215	14.215
	min	2.875	3.35	3.85	3.85	4.85	5.85	5.85	6.82	7.82	9.82	11.785	13.785
dc	max=nominal size (h13)	14	18	22	25	31	37	45	50	58	68	80	92
	min	13.73	17.73	21.67	24.67	30.61	36.61	44.61	49.61	57.54	67.54	79.54	91.46
k	Nominal Size (js15)	9	12	15	18	24	30	36	40	45	54	63	72
	max	9.29	12.35	15.35	18.35	24.42	30.42	36.5	40.5	45.5	54.6	63.6	72.6
	min	8.71	11.65	14.65	17.65	23.58	29.58	35.5	39.5	44.5	53.4	62.4	71.4
s	max=nominal size	10	13	16	18	24	30	36	41	46	55	65	75
	min	9.78	12.73	15.73	17.73	23.67	29.67	35.38	40.38	45.38	54.26	64.26	74.26
e	min	11.05	14.38	17.77	20.03	26.75	33.53	39.98	45.63	51.28	61.31	72.61	83.91
per 1000 units≈kg		6	12	22	30	68	124	219	320	464	790	1290	1970

Nuts of sizes M6 to M36 shall be made of steel of property class 10 (recommended) or 8 as specified in DIN EN 20898-2.

Nuts of sizes M42 and M48 shall have a hardness of (240 + 62) HV 30 (recommended) or (188 + 114) HV 30.

